

产品手册

Product Manual



DISTRIBUTED BY



บริษัท บุญเยี่ยมและสหาย จำกัด

BOONYIUM AND ASSOCIATES LIMITED

1314-1322 ถนนศรีนครินทร์ แขวงอ่อนนุช เขตสวนหลวง กรุงเทพฯ 10250

1314-1322 Srinakarin Road, On Nut, Suanluang, Bangkok 10250, THAILAND

Tel. 02-322-1878 (Auto Line) 02-322-4330-3 Fax. 02-322-4328-8

Burner Section : 02-322-9389-0 Email: burner@boonyium.com

http://www.boonyium.com

让燃烧完美而简约
Make The Combustion Perfect And Simple

COMPANY INTRODUCTION 公司介绍

DYDTEC Group is specialized in combustion industry. Our products and services include industrial burner, combustion system, flame treatment system, air heater, heat exchanger, project renovation for combustion safety, energy saving and low nitrogen, maintenance of combustion system. We see us as a solution provider in the combustion industry and can satisfy the needs from customers.

Over 10 years expanding, DYDTEC has supplied thousand of combustion systems and air heaters. We have rich application experiences in various industries including automotive, environment protection, industrial drying, light industry and heavy industry.

Our product applies the European standard EN746 and American standard NFPA86.

DYDTEC entered overseas market in 2016, we have successfully exported our products to the areas including US, EU, Africa, Asia and Pacific.

With our motto of faith, DYDTEC is dedicated to be excellent, honest, diligent, responsible. We have become the industrial combustion market leader in China and we are ambitious to become an outstanding brand worldwide in the field of industrial combustion in the next decade.





LPP BURNER



LPP serie burner is the direct-fired air heating burner designed based on the safety standard EN746-2 of the EU gas industry. The LPP burner can be installed on the side wall of the furnace to produce a wide range of flame heating area in a short period of time and can be used in a variety of low and medium temperature heating application scenarios such as oven, industrial drying furnace and air heater, especially suitable for working conditions with limited heating space.

- 6 types of specifications optional; all-metal structure
- Capacity : 145kW~870kW
- Stable and clean combustion; low NOx level
- High turndown to 40:1, faster and accurate temperature regulation
- Suitable for natural gas and LPG
- Low gas pressure required
- Integrated design, easy to install, easy to operate, easy to maintain



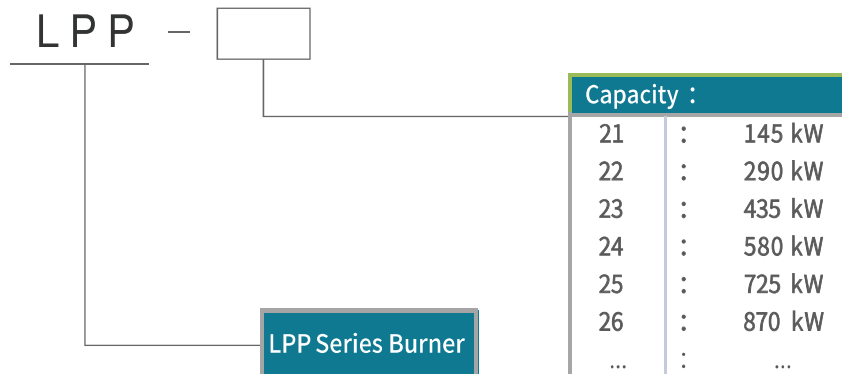

PARAMETERS

Basic Parameters						
Product Type	LPP21	LPP22	LPP23	LPP24	LPP25	LPP26
Rated Capacity (kW) *	145	290	435	580	725	870
Supply voltage of fan (V)	AC380					
Supply voltage of control system (V)	AC220					
Power frequency (Hz)	50					
Inlet pressure of gas pipeline (kPa)	20~30					
Oxygen content of combustion air **	21%					
Maximum applicable temperature (°C)	700					
Flame length (mm)	700					
* — LPP burners have the maximum power up to 1760kW. If the demands exceed the listed power models, please contact the supplier;						
** —When the burner is not used under standard conditions, please contact the supplier.						

02 Application

LPP burner is suitable for a variety of heating scenarios at a low temperature. The appropriate application method can be selected according to conditions.

TYPICAL INTEGRATED APPLICATION DIAGRAM

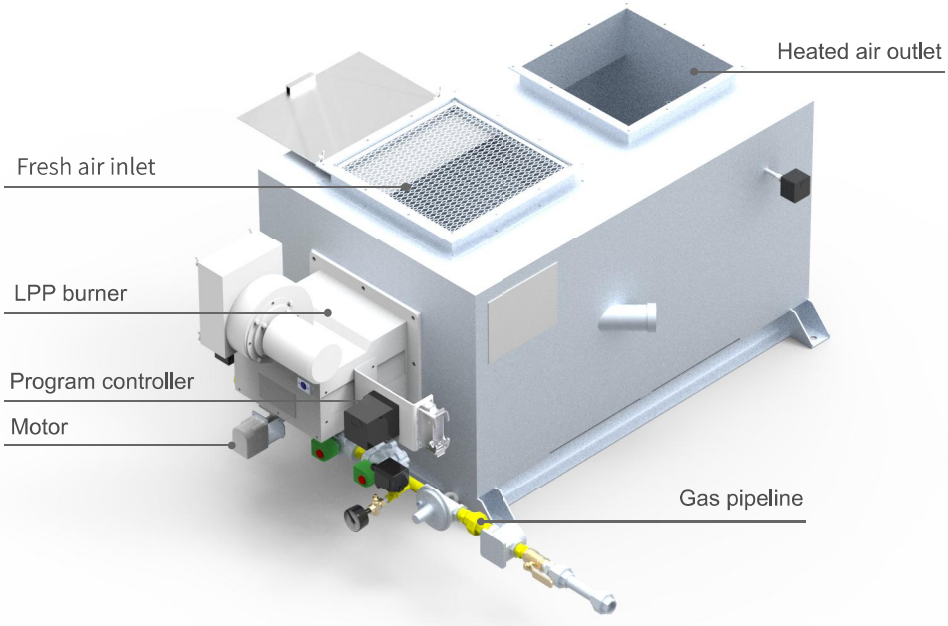

APPLICATION TYPE

No.	Application type	Requirements for working conditions	Schematic diagram
1	Vertical duct application	Requirement for airspeed: 2 ~6m/s	
		Requirement for pipe installation on the burner: $L > 1.5$ m	
		The distance between the edge of the burner nozzle and other directions of the inner duct wall shall not be less than 0.5 m	
2	Elbow duct applications	Requirement for airspeed: 2 ~6m/s	
		Requirement for pipe installation on the burner: $L > 1$ m	
		The distance between the edge of the burner nozzle and other directions of the inner duct wall shall not be less than 0.5 m	

03 Data curve 

Capacity and flame length

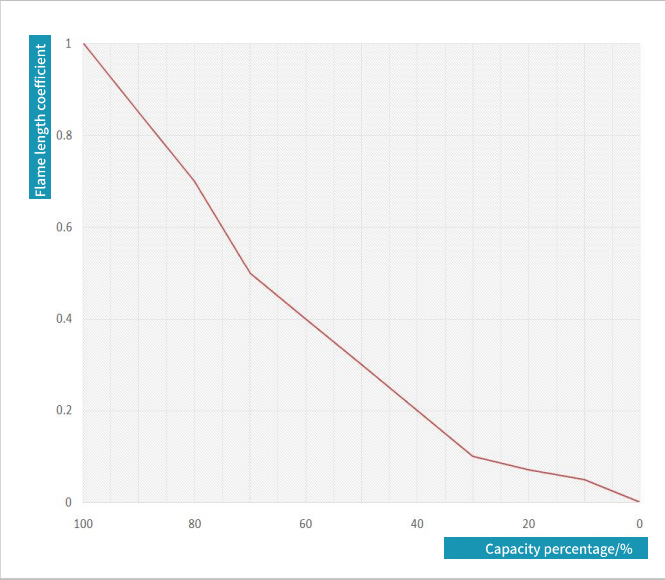

Air pressure drop, air speed and flame length

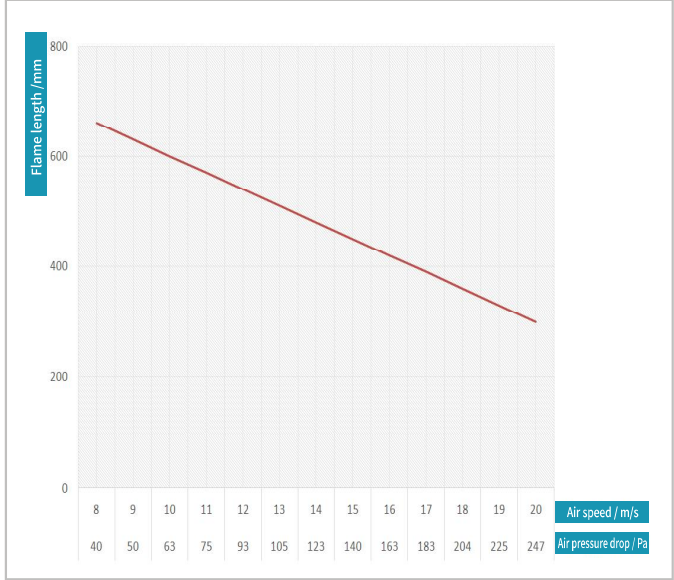

CO emissions
(under the conditions of 15% O₂ / 2mbar of combustion air pressure)

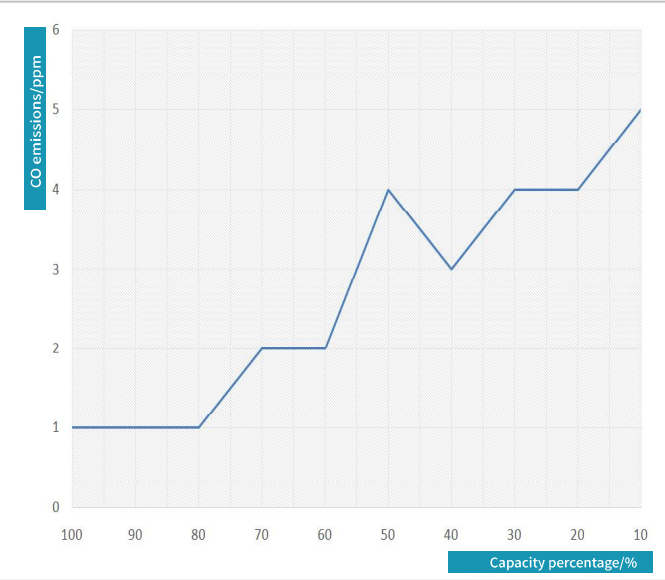

NO_x emissions
(under the conditions of 15% O₂ / 2mbar of combustion air pressure)

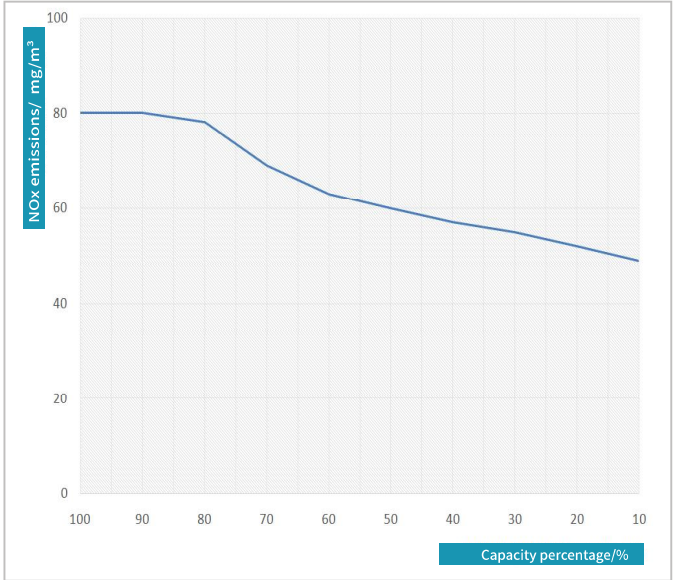

04 Dimensions 

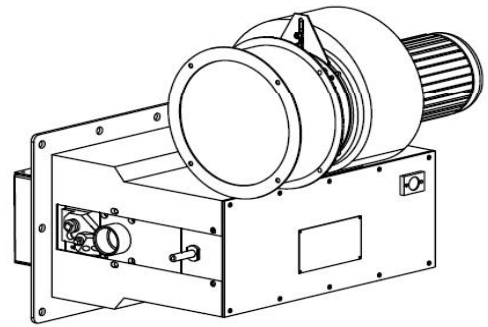
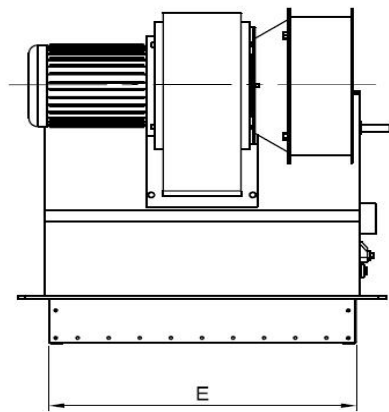
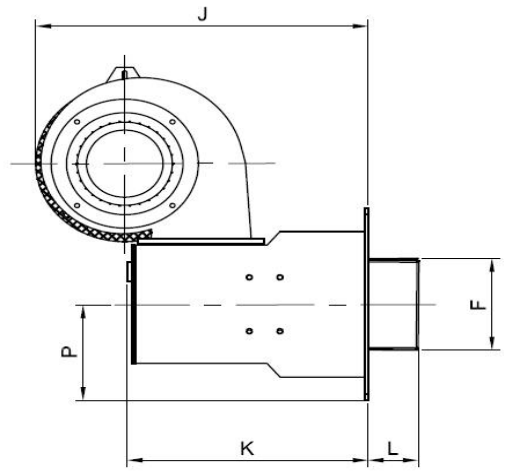
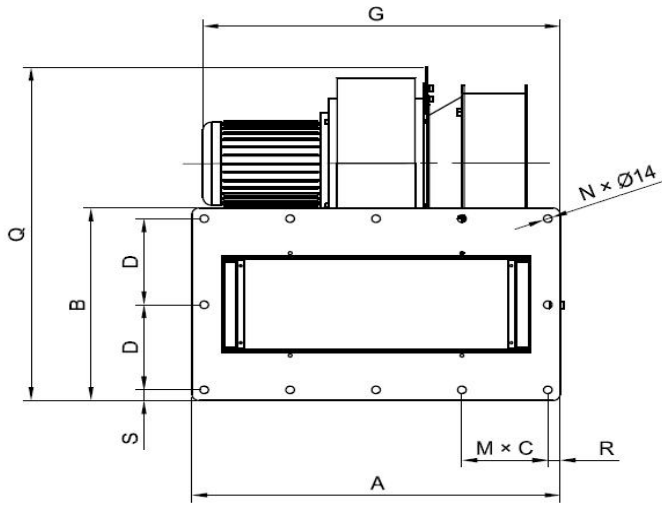

Dimensions (Unit: mm)															Repeat feature (Unit: set)	
Burner Type	A	B	C	D	E	F	G	J	K	L	P	Q	R	S	M	N
LPP21	300	360	131	160	199	173	412	510	358	80	180	610	19	20	2	8
LPP22	450		206		349		487	516	364			610	19		2	8
LPP23	600		140		501		582	542	393			621	20		4	12
LPP24	750		142		653		658	548	399			621	20		5	14
LPP25	902		173		807		816	592	439			661	19		5	14
LPP26	1054		169		959		893	592	439			661	20		6	16

REQUIREMENTS

Before installing the burner, square holes should be drilled on the furnace wall based on the size of burner nozzle. In convenience of installation, the hole size must be at least 12mm larger than the side length of the burner nozzle. The recommended range of the hole size F_0 is $(F+12)_{+8}^0$ mm.

When the thickness of the furnace wall exceeds the length of the burner nozzle, the bell mouth (as shown in the right figure) at an angle of 45° to the horizontal should be reserved on the end face within the furnace wall that exceeds the burner nozzle so as to better protect the furnace wall.

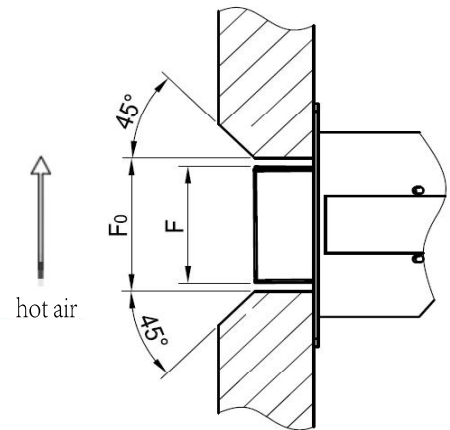

INSTALLATION METHODS

The installation of LPP burner is flexible. The burner body can be installed horizontally and vertically in the direction of flame according to the needs of site working conditions, **and cannot be installed vertically downward.**

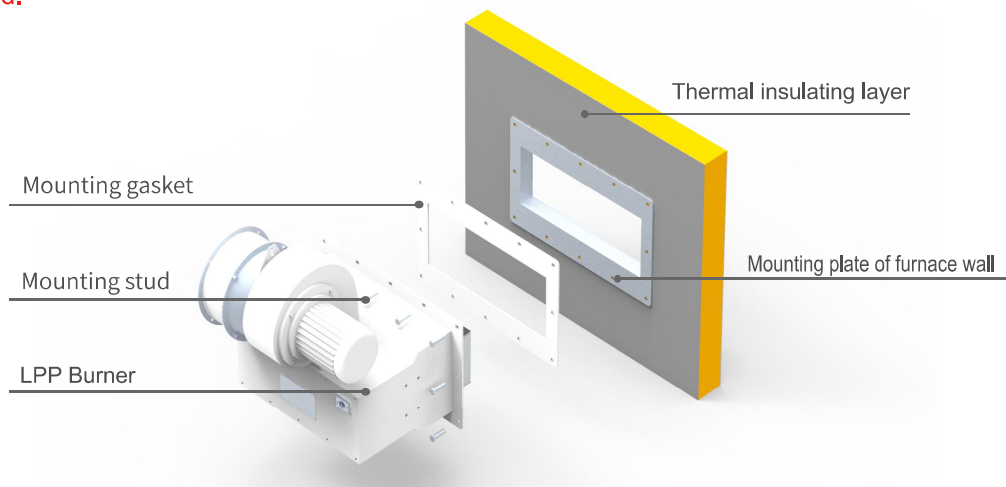



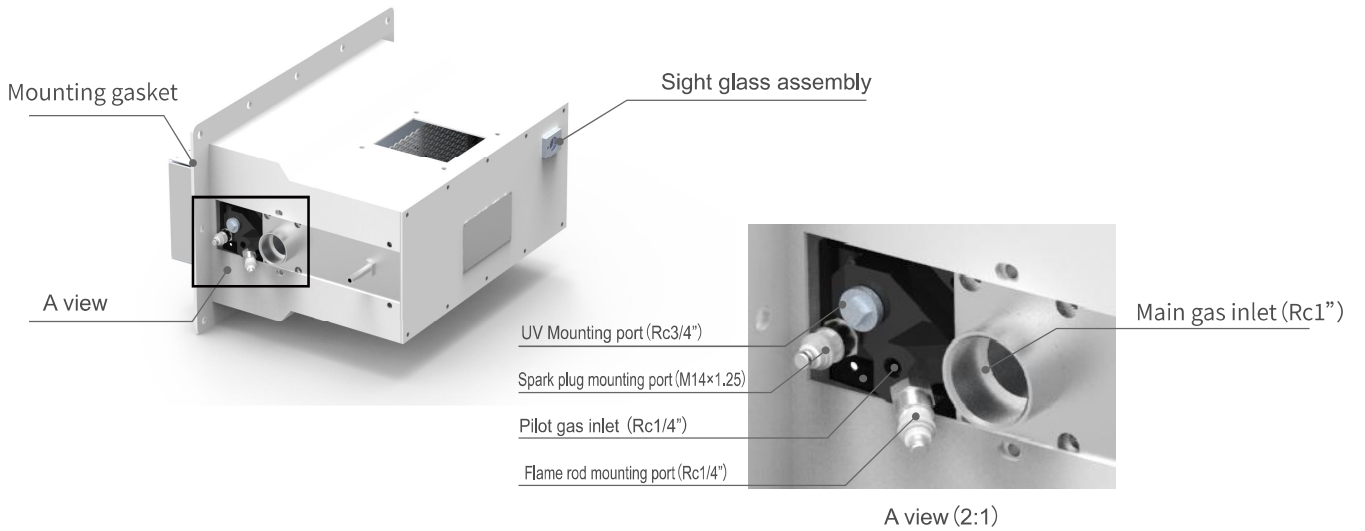

INSTALLATION NOTES

- i. The gap between the burner and the furnace wall is filled and filled with ceramic wool;
- ii. The installation flange of burner and the installation plate of furnace wall shall be sealed with fiber gasket;
- iii. After the furnace is ignited for the first time at the design temperature, please check the shrinkage of the fibers around the burner and refill the gap with fiber refractory materials to ensure the sealing between the inner and outer walls of the furnace.

DIAGRAM OF ACCESSORIES



MAIN ACCESSORIES

NO.	Accessory	Type	Photo	Application
1	Spark plug	RP-SE-L		Suitable for the whole series
2	Flame rod	RP-FE-1/4-150-5-42		Suitable for the whole series
3	Sight glass assembly	ECO30022		Suitable for the whole series
4	Gasket	LPP21GK		Suitable for LPP21
		LPP22GK		Suitable for LPP22
		LPP23GK		Suitable for LPP23
		LPP24GK		Suitable for LPP24
		LPP25GK		Suitable for LPP25
		LPP26GK		Suitable for LPP26

DISTRIBUTED BY



BOONYIUM
Since 1958



บริษัท บุญเยี่ยมและสหาย จำกัด
BOONYIUM AND ASSOCIATES LIMITED
1314-1322 ถนนศรีนครินทร์ แขวงอ่อนนุช เขตสวนหลวง กรุงเทพฯ 10250
1314-1322 Srinakarin Road, On Nut, Suanluang, Bangkok 10250, THAILAND
Tel. 02-322-1878 (Auto Line) 02-322-4330-3 Fax. 02-322-4328-8
Burner Section: 02-322-0389-8 Fax. 02-322-0389
http://www.boonyium.com Email: burner@boonyium.com

DYDTEC COMBUSTION

Add: Floor 1&4 of Building 1, No.111 Zhiye Road Pudong District, China

Tel: 86-21-58814568

E-mail: info@dydtec.com

Web: www.dydtec.com

